

PROPOSED GUNNOCKS TO CORDUFF UG 220 kV CIRCUIT 2

SECTION 6-6
Scale 1:50

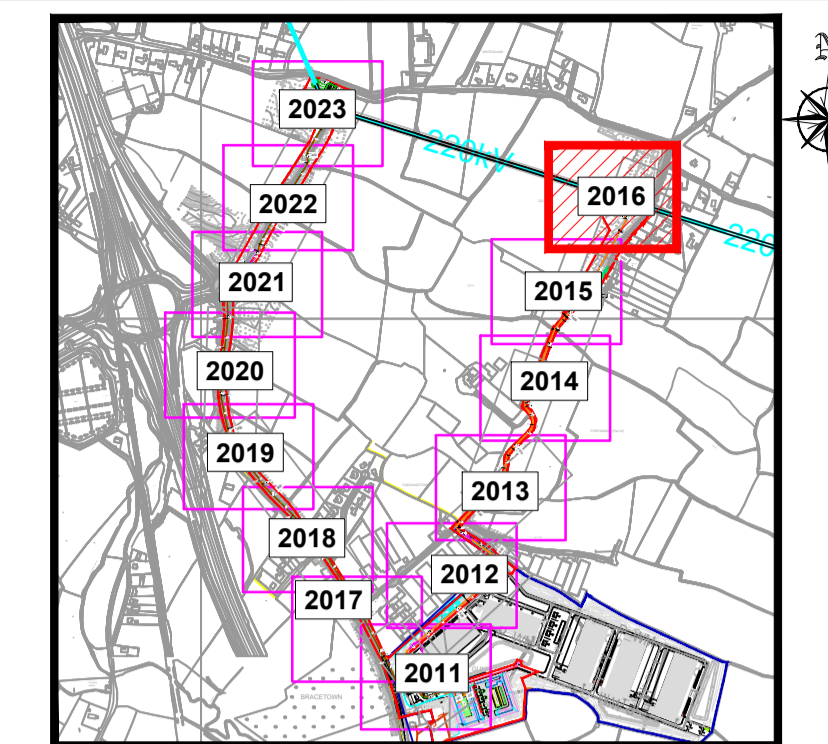

SITE MAP LOCATION

LEGEND:

- APPLICATION SITE BOUNDARY
- LANDS IN APPLICANT'S CONTROL
- EXISTING RIGHT OF WAY / WAYLEAVE
- Proposed 4m Wide Access Path For Details Refer to Dwg. A1045-CSE-HEL-XX-DR-C-2031
- 220 kV GRID ROUTE:
- PROPOSED 220 kV UG CIRCUIT 1 GUNNOCKS TO WOODLAND
- PROPOSED 220 kV UG CIRCUIT 2 GUNNOCKS TO CORDUFF
- PROPOSED 8m JOINT BAYS
- GROUND LEVEL
- EXISTING SERVICES
- EXISTING OVERHEAD HV LINES
- EXISTING ESB
- EXISTING ESB OVERHEAD
- EXISTING GAS
- EXISTING TELECOMS
- EXISTING FOUL
- EXISTING WATERMAIN

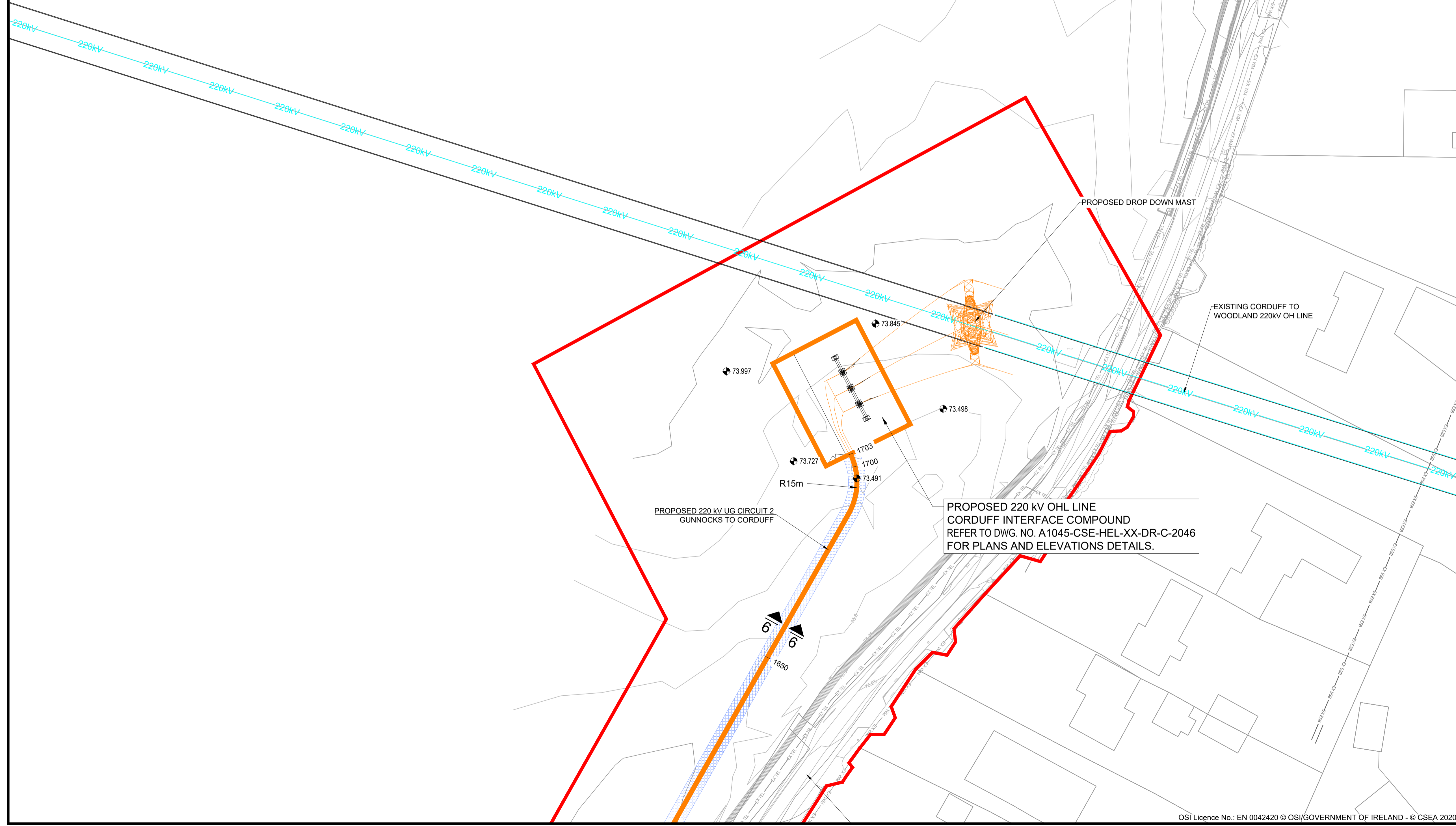

PROPOSED 220 kV OH LINE CORDUFF INTERFACE COMPOUND REFER TO DWG. NO. A1045-CSE-HEL-XX-DR-C-2046 FOR PLANS AND ELEVATIONS DETAILS.

P02	ISSUE FOR PLANNING	ZS	CD	30/07/2020
P01	DRAFT FOR PLANNING	ZS	CD	17/07/2020
Rev	Description	Drawn	Checked	Date

Clifton Scannell Emerson Associates Limited
 Consulting Engineers,
 Seaforth Lodge,
 Castledawson Avenue,
 Blackrock, Co. Dublin,
 Ireland, A94 P768
 T. +353 1 288 5006
 F. +353 1 283 3466
 E. info@csea.ie
 W. www.csea.ie

Client	ENGINENODE		
Project	ENGINENODE 220 kV SUBSTATION AND GRID CONNECTION		
Dwg. Title	PROPOSED 220 kV ROUTE LAYOUT PLAN & SECTION SH 6 OF 13		
Drawn By	PH	Date	23-04-2020
Checked By	CD	Scale	1:500 @ A1
Project Code	Originator	Zone/Phase	Level Type Role Dwg. No.
S2	FOR INFORMATION		
P02	PLANNING		